

OFFICE BUILDING FOR SALE

235 BROOKSITE DRIVE HAUPPAUGE, NY



BUILDING SPECIFICATIONS:

Building Size: +/- 13,485 SF
Plot: +/- 1.17 Acres
Parking: 5:1,000 SF

RE TAXES: \$44,899.68 (\$3.32 PSF)
SALE PRICE: \$2,890,000.00 (\$214.31 psf)

COMMENTS:

- 2-Story Class C Office Built 1989.
- Great access to Northern State Pkwy, L.I.E., Vets Hwy & Rte 111.
- Property Manager On Site.
- Utilities: Gas, Electric & Water
- Nicely Landscaped.
- Very Well Maintained.

EXCLUSIVE AGENT:

STEVEN D'ORAZIO | Associate
631.389.2900 x 232
sdorazio@suttonandedwards.com

1981 MARCUS AVENUE
LAKE SUCCESS, NY 11042
T. 516.328.6500
F. 516.328.6749

200 THIRTEENTH AVENUE
RONKONKOMA, NY 11779
T. 631.389.2900
F. 631.389.2920

www.suttonandedwards.com

Although the information furnished regarding property for sale, rental or financing is from sources deemed reliable such information has not been verified and no express representation is made nor is any to be implied as to the accuracy thereof and it is submitted subject to errors, omissions, change of price, rental or other conditions prior to sale, lease or financing or withdrawal without notice.



SITE PLAN:

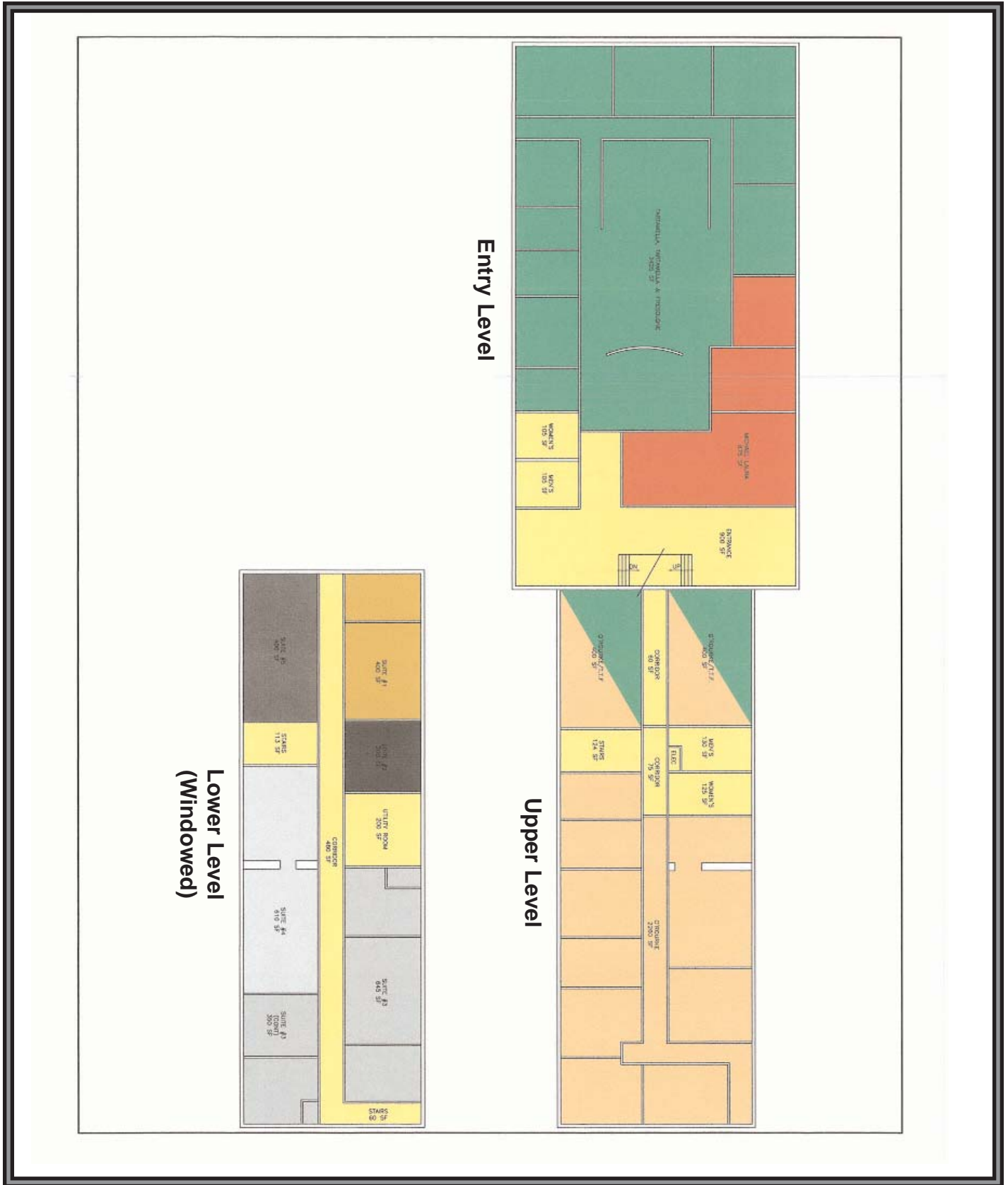

Although the information furnished regarding property for sale, rental or financing is from sources deemed reliable such information has not been verified and no express representation is made nor is any to be implied as to the accuracy thereof and it is submitted subject to errors, omissions, change of price, rental or other conditions prior to sale, lease or financing or withdrawal without notice.